

## Installing open joint FXCJoint

### Application

FXCJoints are i.a. used as repair joints in freely suspended systems.

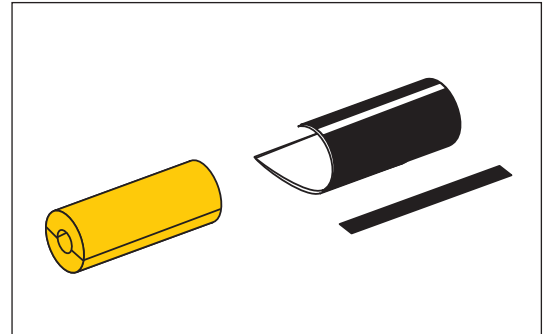

### Installation tips

#### Important:

Never heat directly on any creases, otherwise the surface of the shrink wrap may discolour and crack at the surface.

Never heat under the wrap at the ends, otherwise the wrap may be damaged permanently.

Use burner head  $\varnothing 50\text{mm}$  for shrink wrap up to  $\varnothing 210\text{ mm}$ . For larger shrink wraps use burner head  $\varnothing 60\text{ mm}$ .

### Installation

1. Heat the entire old shrink sleeve..

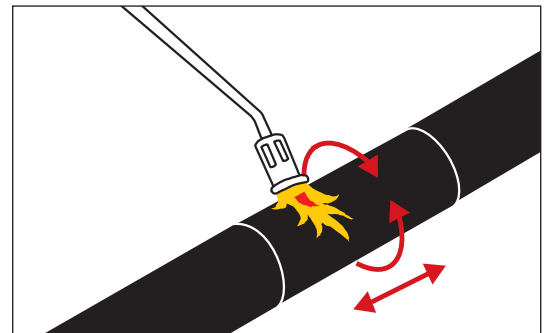

2. Cut the old shrink sleeve longitudinally with a sharp knife. Remove the shrink sleeve.

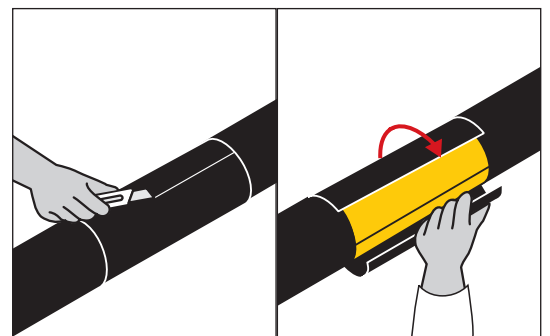

3. Clean all surfaces in the jointing area.

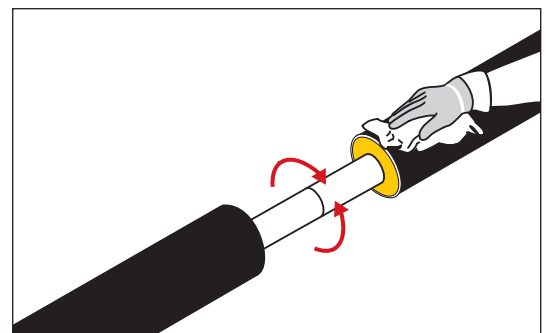

## Installing open joint FXCJoint

### Installation, continued

4. Shorten the insulation shells so they fit tightly between the casing pipes.

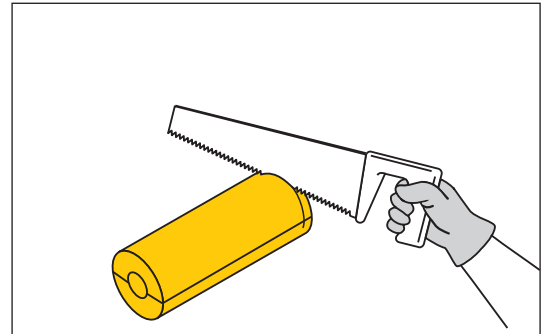

5. Install the insulation shells tightly between the casing pipes, using adhesive tape, if required.  
All surfaces must be CLEAN and DRY.  
Now clean the casing surface with alcohol.

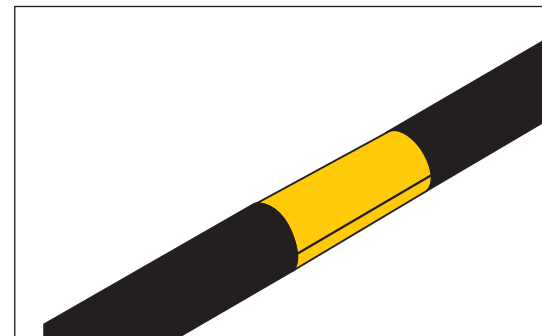

6. Activate the casing pipes with emery cloth (grain size 60 up to  $\varnothing$  280 mm and grain size 36 for major dimensions), so grind marks will be visible outside the rim of the shrink wrap.  
Remove grind dust, if any, and avoid touching the ground contact surfaces.

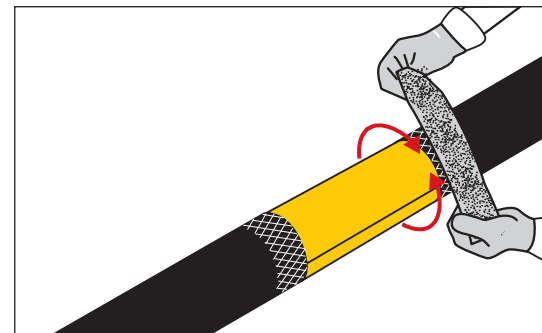

7. Activate the casing pipes with gas burner to a surface temperature of min. min. 65°C.

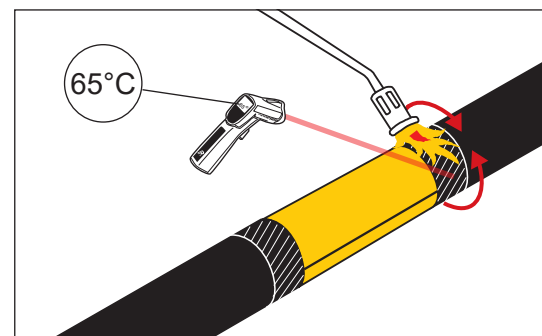

8. Remove the paper from the shrink wrap, while pulling the wrap into position.  
The text must go around the pipe, and the joint must be at the top.  
The wrap must fit loosely around the pipe with an overlap of min. 50 mm.

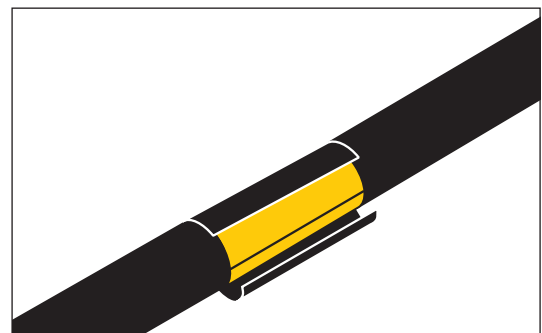

## Installing open joint FXCJoint

### Installation, continued

9. Centre the closure patch on the wrap joint with the adhesive side facing down. The adhesive side has a visible reinforcement. Heat the closure patch until the reinforcement structure becomes visible on the top side. Press down the closure patch. Now roll on the closure patch with the roller to ensure good adhesion. Alternatively, use a patch press.

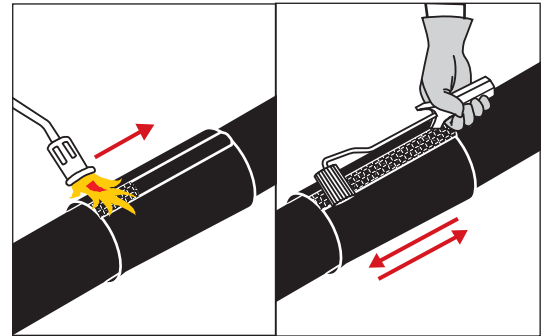

10. Shrink the wrap from the centre towards both ends, ensuring that sealing compound spreads to all ends, and the full shrinking effect has been utilised.

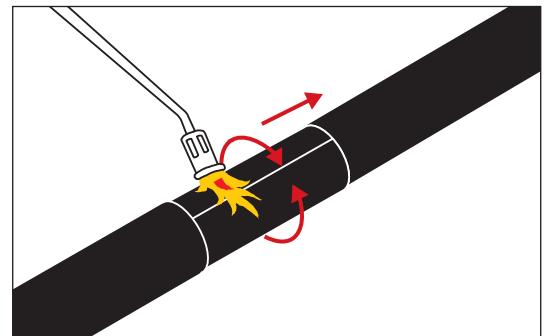

11. Roll along the overlapping edge, ensuring that any tunnel is sealed with sealing compound.

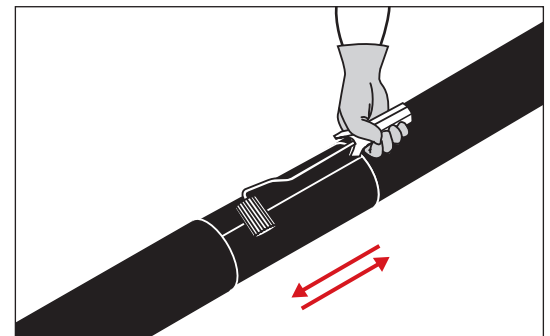

12. The joint is complete.

